



This quick start guide is intended to provide a brief overview of the main features and operation of PIPETBOY GENIUS. For detailed information, please refer to the latest operating instructions, which can be found at www.integra-biosciences.com in several languages.

Intended use

PIPETBOY GENIUS is a pipet controller designed for aspirating and dispensing aqueous solutions with plastic or glass pipettes in a volume range of 0.1 to 100 ml. The features overflow protection and repeat dispense are only possible with INTEGRA serological pipettes. It is intended laboratory use only. Any use of this instrument in a medical or IVD setting is the responsibility of the user.

⚠ Safety information

- 1) Do not use or charge PIPETBOY GENIUS in an environment that may contain combustible gases or liquids. Do not pipette highly flammable liquids, such as acetone or ether.
- 2) Comply with the material safety data sheet (MSDS) and all safety guidelines when handling dangerous substances. Use protective clothing and safety goggles. Never point a pipet at another person.
- 3) Avoid pipetting liquids with vapours that could degrade the materials PP (housing), POM, PVC, PBT, PET (internal plastic parts) or silicone (tubings, seals). Corrosive vapours could also damage metallic or electronic parts inside the device.
- 4) Use an original INTEGRA Biosciences mains adapter only. Protect it from moisture to avoid damaging the PIPETBOY GENIUS.

Regardless of the listed safety notes, observe all additional applicable regulations and guidelines of trade associations, health authorities, trade supervisory offices, etc.

Battery charge

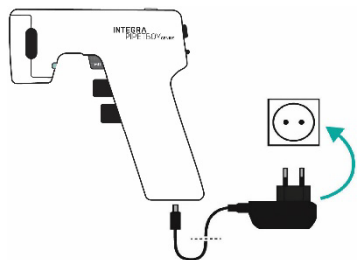

Plug in

Charge the LiPo battery completely before first use.



Only use the original LiPo battery for PIPETBOY GENIUS.

The supply voltage must meet the requirements of the mains adapter: 100-240 VAC, 50/60 Hz.

Getting started

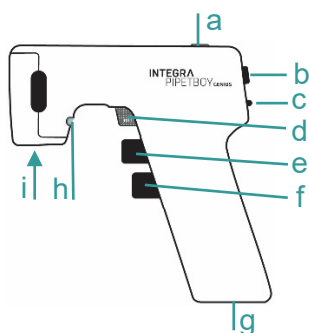

- a. Display, shows the aliquot dispense volume
- b. Volume wheel
- c. Speed slider
- d. Repeat dispense button
- e. Aspirate button
- f. Dispense button
- g. Socket and battery compartment
- h. INTEGRA pipet indicator
- i. Nose piece, click pipet in

Turn on: Press the repeat dispense button (d) for 3 seconds.

Turn off (required for disassembly): Press the volume wheel (b) in the middle. Move the cursor down by tapping the volume wheel to the left, highlight “Shutdown” and press in the middle to confirm.

INTEGRA

Speed setting

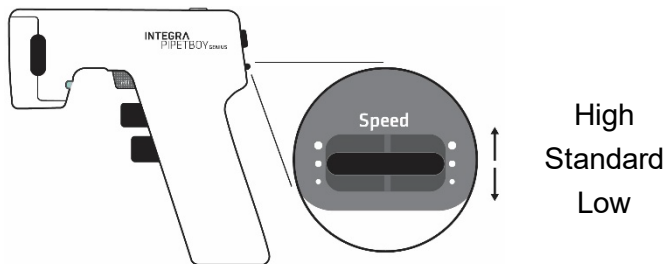

Manual speed control

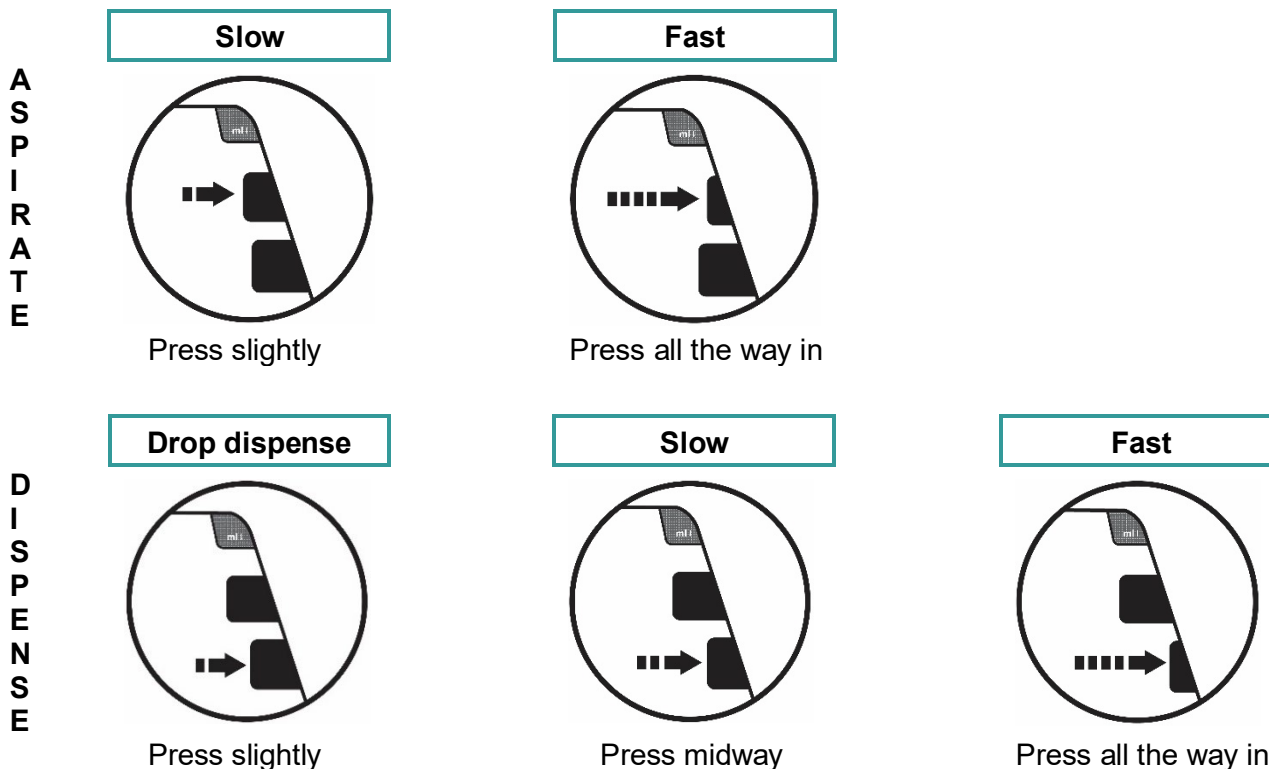

Repeat dispense (INTEGRA pipets only)

Note: The device automatically detects the pipet volume via its color code.

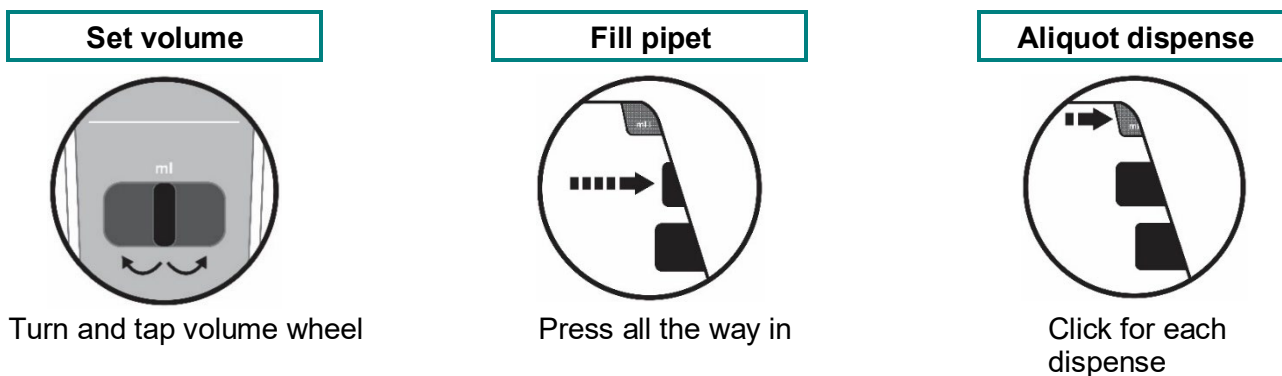

Repeat dispensing on the PIPETBOY GENIUS is more precise than dispensing manually. The liquid level may vary from the graduation mark, as serological pipets are only calibrated at their maximum volume. Scan here for more details.



INTEGRA

Filter exchange



Always switch off the device and disconnect from the electricity supply before disassembly, or when carrying out maintenance work.

Changing the hydrophobic filter every 3 months is recommended. The filter must be changed immediately if wetted or soiled.

Remove the nose piece from the side

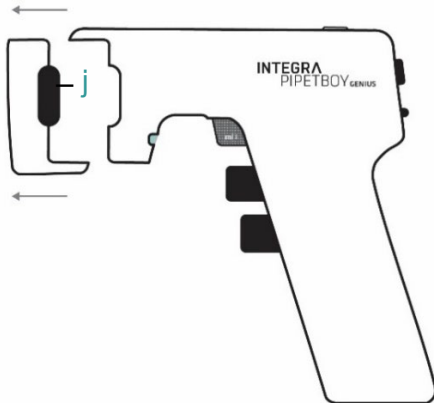

Press black snap fit (j) on both sides.

Replace the filter

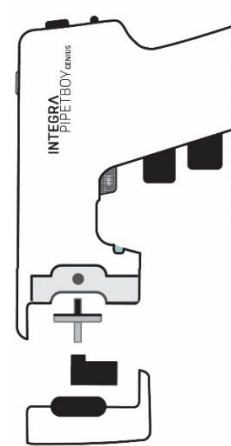

Cleaning and Decontamination

- If the PIPETBOY GENIUS is soiled, it can be cleaned with a cloth moistened with soapy water or with a 70 % solution of ethanol.
- The nose piece housing and silicone pipet mount can be autoclaved at 121 °C, 1 bar pressure for 20 minutes. Silicone may become brittle after extensive autoclaving. Replace the pipet mount if it is damaged.
- The device may be decontaminated with H₂O₂ gas (maximal concentration 35 %) for 60 minutes.

Equipment disposal



PIPETBOY GENIUS devices must not be disposed of with unsorted municipal waste. Do not incinerate.



PIPETBOY GENIUS contains a LiPo battery. Do not modify the battery in any way. Dispose of the PIPETBOY GENIUS and battery separately, in accordance with the laws and regulations in your area for the disposal of devices containing LiPo batteries.

In certain regions and countries, e.g. in EU member states, the distributor is obliged to take back this product free of charge at the end of its life. Please contact your local distributor for more details.

Manufacturer and customer service

INTEGRA Biosciences AG Tardisstrasse 201 7205 Zizers, Switzerland	INTEGRA Biosciences Corp. 22 Friars Drive Hudson, NH 03051, USA	Find your local representative: www.integra-biosciences.com info@integra-biosciences.com
Direct sales country	Telephone	Mail
Australia	+617 3497 5800	info-au@integra-biosciences.com
Benelux	+31 630 609 866	info-benelux@integra-biosciences.com
China	+86 21 5844 7203	info-cn@integra-biosciences.com
Denmark, Sweden	+45 3173 5373	info-nordic@integra-biosciences.com
France	+33 1 34 30 76 76	info-fr@integra-biosciences.com
Germany, Austria	+49 6409 81999 15	info-de@integra-biosciences.com
Japan	+81 3 5962 4936	info-jp@integra-biosciences.com
Switzerland	+41 81 286 95 30	info-ch@integra-biosciences.com
United Kingdom, Ireland	+44 1635 797000	info-uk@integra-biosciences.com
United States, Canada	+1 603 578 5800	info-us@integra-biosciences.com



Declaration of conformity

INTEGRA Biosciences AG – 7205 Zizers, Switzerland

declares on its own responsibility that the devices

Description	Models
PIPETBOY GENIUS	1011, 1012, 1013, 1014, 1015, 1016
Accessories	1200, 1201, 1202, 1203, 1210

comply with:

EU directives and regulations

2014/35/EU, 2014/30/EU, 2012/19/EC, 2011/65/EC, 2006/66/EC, 1907/2006, 2019/1782, 1103/2010

GBR regulations

S.I. 2016/1101, S.I. 2016/1091, S.I. 2008/2164, S.I. 2013/3113, S.I. 2012/3032

Zizers, March 25, 2024

Urs Hartmann
CEO

Daniela Gross
Head of Corporate Quality

Please refer to the operating instructions at www.integra-biosciences.com for detailed CE declaration and regulations of other countries.