

Master_mix_prep_in_reservoir Report

Program Name (on pipette)

Master-Mix-Prep

User Credentials

Name: rebecca.bodmer

Date: 20. Jan. 2023

Overview Method

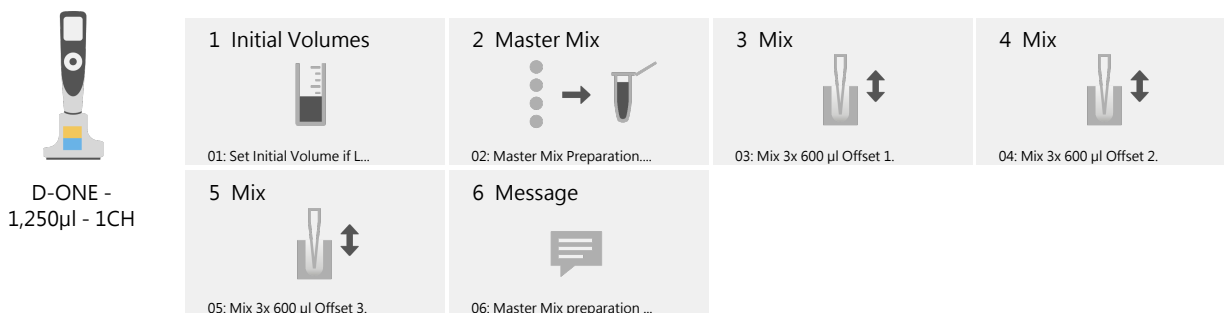

Total Time: 3 min 1 sec

Total Tip Consumption: Tip 125µl: 2

Tip 1250µl: 3

Description

Master Mix Preparation in divided reservoirs

Material:

Pipette: D-ONE 50/1250 µl 1 CH

A: Dual Adapter

B: Rack for 2 ml tubes with screw caps and 1.5 ml microcentrifuge tubes

C: Empty

Method:

01: Set Initial Volume if Liquid Level Detection is turned off.

02: Master Mix Preparation. Adjust Variables.

03: Mix 3x 600 µl Offset 1.

04: Mix 3x 600 µl Offset 2.

05: Mix 3x 600 µl Offset 3.

06: Master mix preparation finished.

Deck Layout

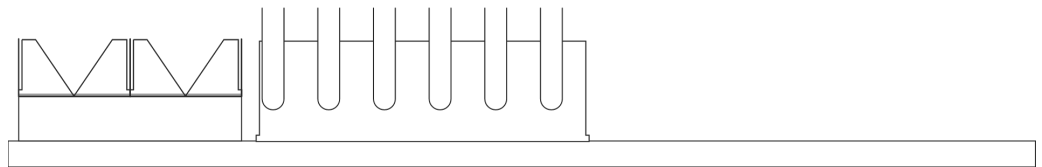
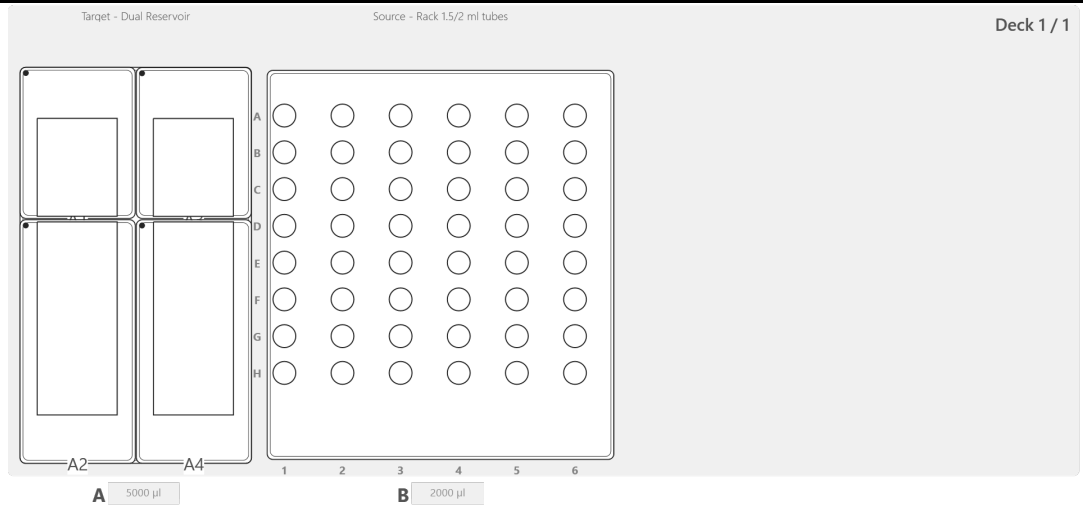
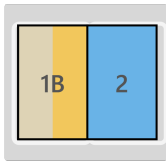

Pipette & Deck

Labware	Name	Manufacturer	Part Number
Pipette	D-ONE 5 - 1,250 µl 1 channel	INTEGRA	4532
Pipette Tip	50/125 µl GripTip, Sterile, Filter	INTEGRA	6465
Pipette Tip	1250 µl GripTip, Sterile, Filter	INTEGRA	6445
Deck	3 Position Universal Deck	INTEGRA	4520

Deck Labware

Deck Position	Labware	Name	Manufacturer	Part Number	Description
A	COMBI System	Dual Reservoir Adapter		4547	- compatible with 10 ml Multichannel Reagent Reservoirs 25 ml Multichannel Reagent Reservoirs 12 Well Reagent Reservoirs Divided Reagent Reservoirs - holds up to 2 reservoirs (of the same or different type)
	A1	Divided Reagent Reservoir 5 ml compartment (Insert)	INTEGRA	4304, 4351, 4352, 4356, 4357	Polystyrene or Polypropylene use with Dual Reservoir Adapter (PN 4547) only
	A2	Divided Reagent Reservoir 10 ml compartment (Insert)	INTEGRA	4304, 4351, 4352, 4356, 4357	Polystyrene or Polypropylene use with Dual Reservoir Adapter (PN 4547) only
	A3	Divided Reagent Reservoir 5 ml compartment (Insert)	INTEGRA	4304, 4351, 4352, 4356, 4357	Polystyrene or Polypropylene use with Dual Reservoir Adapter (PN 4547) only
	A4	Divided Reagent Reservoir 10 ml compartment (Insert)	INTEGRA	4304, 4351, 4352, 4356, 4357	Polystyrene or Polypropylene use with Dual Reservoir Adapter (PN 4547) only
B	Tube Rack	Rack for 2 ml microcentrifuge tubes with screw caps - 2000 µl	INTEGRA	4540	6x8 2 ml microcentrifuge tubes Reference Tube: Greiner PN 722201
D	Waste				

Method

1 Initial Volumes



Description:

01: Set Initial Volume if Liquid Level Detection is turned off.

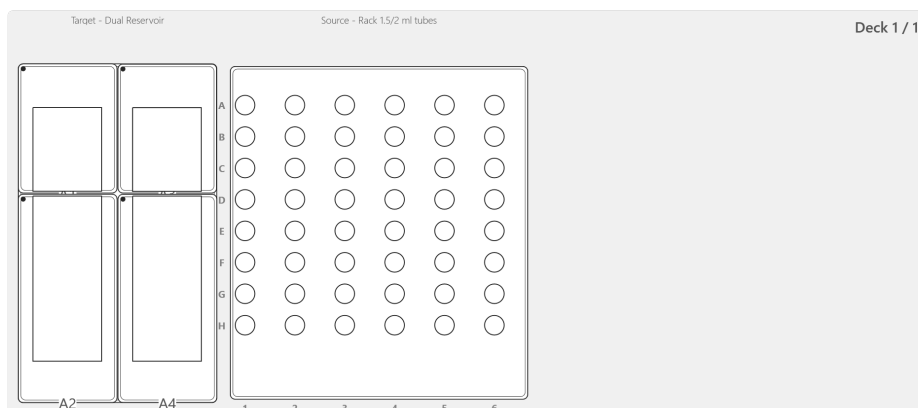

2 Master Mix



Time:
1 min 54 sec
Used Tips:
Tip 125µl: 2
Tip 1250µl: 2

Description:
02: Master Mix Preparation. Adjust variables.

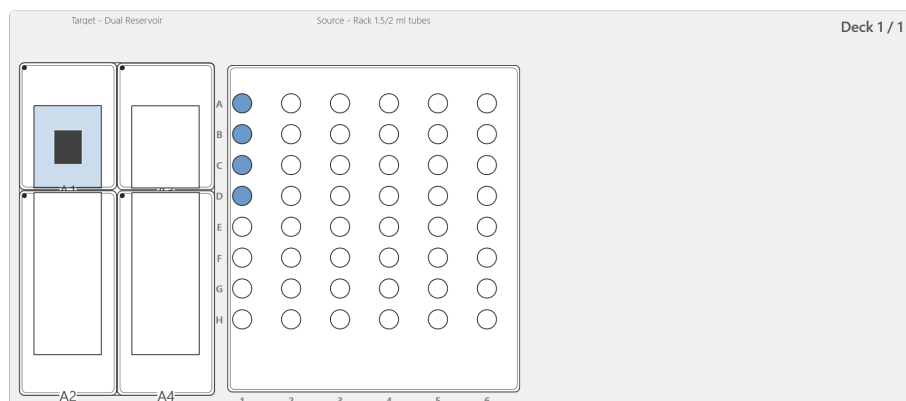

Summary individual transfers

Step	Source			Target			Volume [µl]
	Deck Position	Well Positions	Start Height [mm]	Deck Position	Well Positions	Start Height [mm]	
1	B	A1	LLD	A	1	19.3 mm	294
2	B	B1	LLD	A	1	19.3 mm	490
3	B	C1	LLD	A	1	19.3 mm	49
4	B	D1	LLD	A	1	19.3 mm	49

Pipetting settings

Tab	Parameter	Set value
Volumes	Volume	Variable
Pipetting Speeds	Aspiration Speed Aspiration Delay Dispense Speed Dispense Delay Exit Liquid Slowly Aspirate Dispense	Tip 125µl: 8 Tip 1250µl: 8 0 Tip 125µl: 10 Tip 1250µl: 10 0 No No
Pipetting Height	Source: Heights Tip Travel Safety Bottom Offset Target: Heights Tip Travel Safety Bottom Offset	Source: B: Variable Yes B: Tip 125µl: 4.9 mm Tip 1250µl: 2 mm Target: A1: Variable No A1: Tip 125µl: 2 mm Tip 1250µl: 2 mm
Tip Change	Tip Change	After each reagent
Tip Touch	Tip Touch	No
LLD Settings	Liquid Level Detection If no liquid detected Submerge depth	Yes Ask user B: 2mm

3 Mix



Time:
0 min 26 sec
Used Tips:
Tip 1250µl: 1

Description:
03: Mix 3x 600 µl Offset 1.

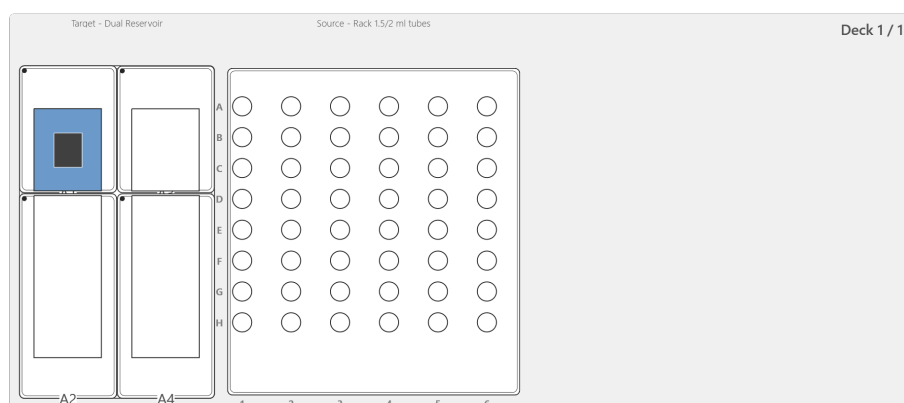

Pipetting settings

Tab	Parameter	Set value
Tip Change	Tip Change	Continue to next step without change
Tip Touch	Tip Touch	No
Extras	Source: Target: Offset X Offset Y	Source: Target: A1: 0 mm A1: 10 mm

Mix Summary

Mix Target

Target				
Step	Deck Position	Well Positions	Pipetting Height	Volume [µl]
1	A	A1	19.1 mm	600

Tab	Parameter	Set value
Mix	Source: Mixing Target: Mixing Mix Cycles Mix Speed Tip Travel	Source: No Target: Yes 3 Tip 125µl: 8 Tip 1250µl: 5 No

4 Mix



Time:
0 min 13 sec
Used Tips:

Description:
04: Mix 3x 600 µl Offset 2.

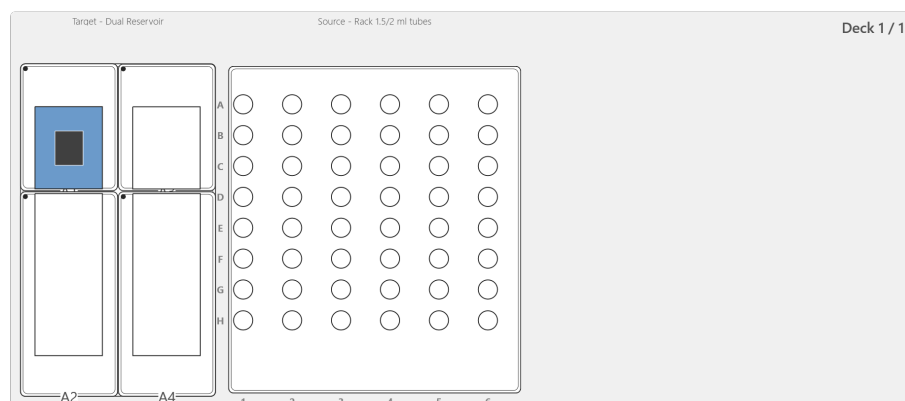

Pipetting settings

Tab	Parameter	Set value
Tip Change	Tip Change	Continue to next step without change
Tip Touch	Tip Touch	No
Extras	Source: Target: Offset X Offset Y	Source: Target: A1: 0 mm A1: -10 mm

Mix Summary

Mix Target

Target				
Step	Deck Position	Well Positions	Start Height [mm]	Volume [µl]
1	A	A1	19.3 mm	600

Tab	Parameter	Set value
Mix	Source: Mixing Target: Mixing Mix Cycles Mix Speed Tip Travel	Source: No Target: Yes 3 Tip 125µl: 8 Tip 1250µl: 5 Yes

5 Mix



Time:
0 min 22 sec
Used Tips:

Description:
05: Mix 3x 600 µl Offset 3.

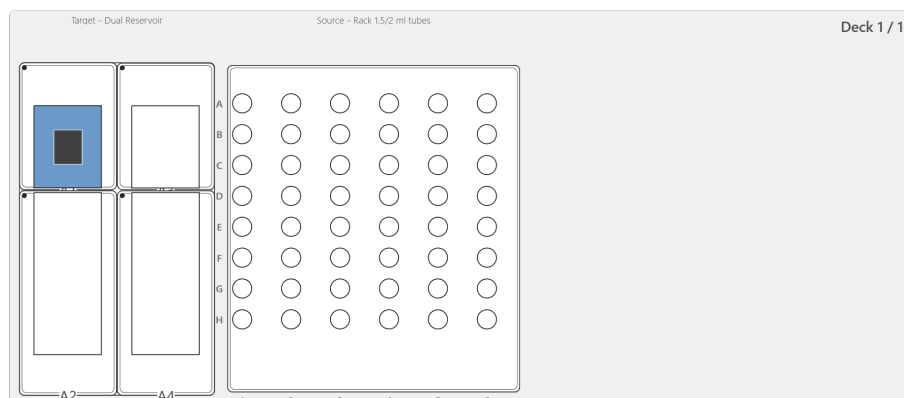

Pipetting settings

Tab	Parameter	Set value
Tip Change	Tip Change	After step complete
Tip Touch	Tip Touch	No

Mix Summary

Mix Target

Target				
Step	Deck Position	Well Positions	Start Height [mm]	Volume [µl]
1	A	A1	19.3 mm	600

Tab	Parameter	Set value
Mix	Source: Mixing Target: Mixing Mix Cycles Mix Speed Tip Travel	Source: No Target: Yes 3 Tip 125µl: 8 Tip 1250µl: 5 Yes

6 Message



Description:

06: Master Mix preparation finished.

Pipetting settings

Tab	Parameter	Set value
Message	Message Line 1 Message Line 2 Message Line 3	Master Mix Preparation finished

Run Protocol

Program Name Program Name (on pipette)	Master_mix_prep_in_reservoir.iaa Master-Mix-Prep
Instrument - Serial Number ASSIST PLUS	
Pipette - Serial Number D-ONE - 1,250µl - 1CH	
Pipette Tips - Lot Number 1250 µl GripTip, Sterile, Filter	
Notes:	
Run Operator:	
Run Date:	
Run Start Time:	
Run End Time:	
Signature:	